

Morris Oujesky
Water well drilled to 220 ft
on November 11, 2007. Well
flowed gas for 2 months following
installation.

Stephen Hurst
Water well drilled to 180 ft
on October 15, 2005. Well
has natural gas coming into
well at intermittent times.

Richard Lipscomb
Water well drilled to 170 ft
in Jan 2007. Hole collapsed.
"...it was never cased because
there's so much gas in it they
couldn't get it cased."
Depo. Peck 12-30-10 pg 32

Lake Country Acres (PWS)
Natural gas compounds detected
in water since 1995. Aeration
occurs in storage tanks to help
in the removal of natural gas.
In 2003, the PWS drilled the No. 4
well that flowed 122 MCFPD and was
plugged because the well produced
more natural gas than water.

Richard Hayley
Domestic Well 2
per EPA Order

Steven Lipsky
Domestic Well 1
per EPA Order

Butler Unit #1H
Wellbore Path

Teal Unit #1H
Wellbore Path

Center Mill (Strawn)
Perf Interval 358 - 426

3000 ft radius

Approximately 1.2 Miles

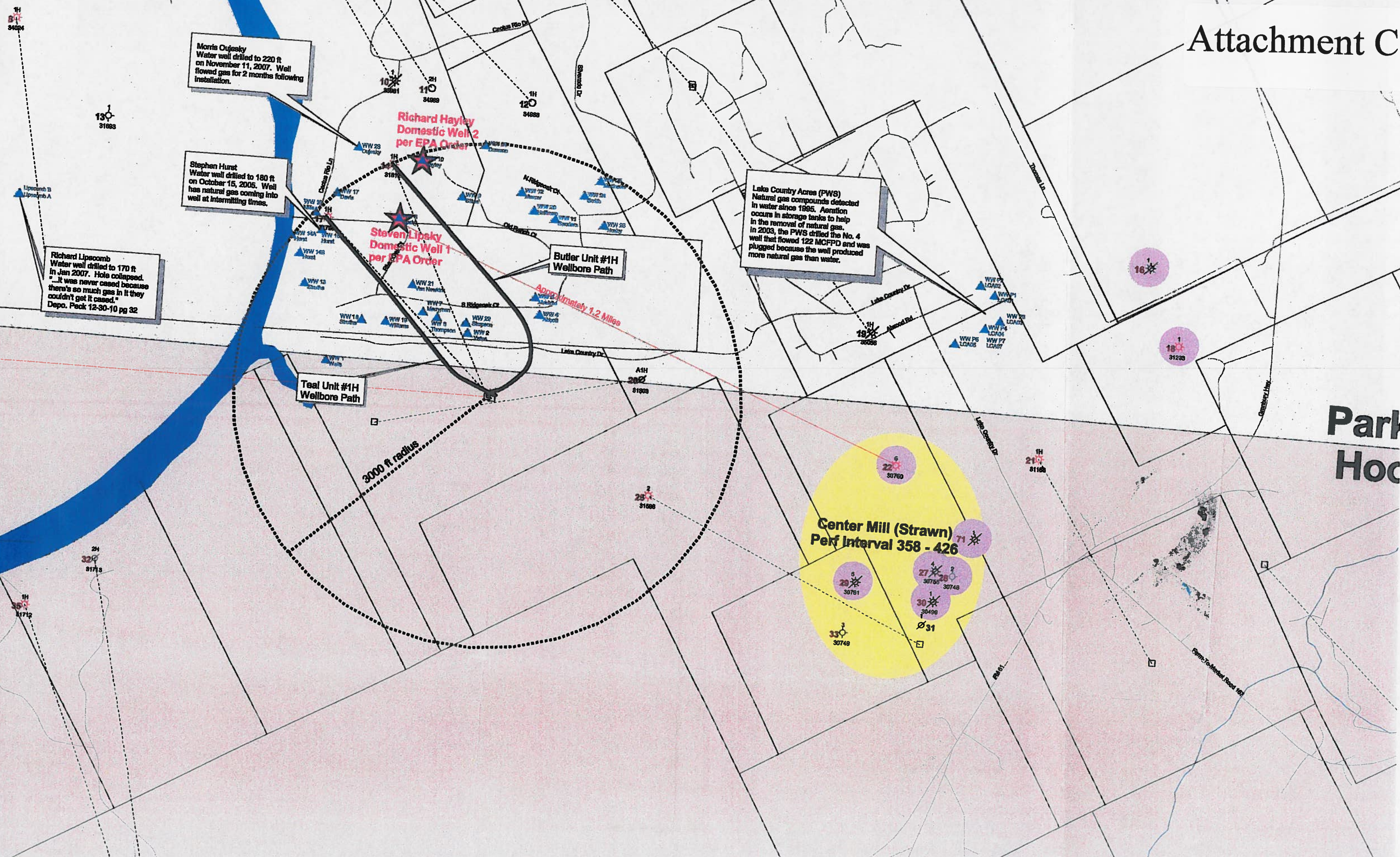

Park
Hoc