

1 inch = 750 Feet
 0 375 750
 Feet



Total Unit Acres: 88.079

VANTAGE FORT WORTH ENERGY, LLC
 ROSEDALE SOUTH WEST 6H
 SITUATED IN THE J.A. CREARY, ABSTRACT 269; U. WUTHRICK, ABSTRACT 1693;
 G.J. ASHABRANNER, ABSTRACT 7 TARRANT COUNTY, TEXAS

APPENDIX 4



DRAWN BY: WJAMES DATE: 10-10-2016

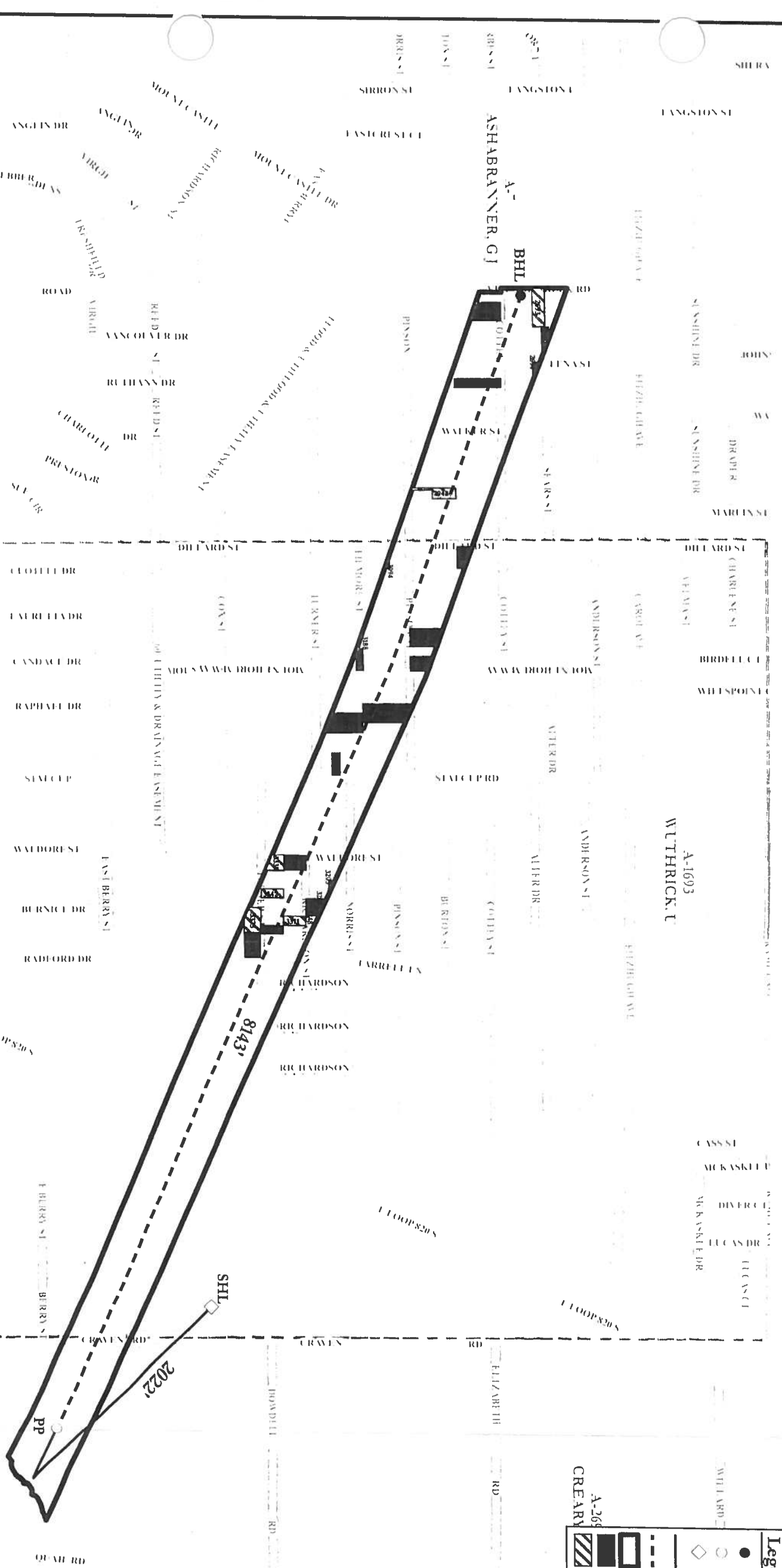

Legend

- PROPOSED BOTTOM HOLE LOCATION (BHL)
- FIRST PERFORATION POINT
- ◇ PROPOSED SURFACE HOLE LOCATION (SHL)
- KICK
- - - LATERAL
- ▭ MIPA UNIT BOUNDARY
- ▭ Unleased
- ▨ Partial Lease

| ROSEDALE SOUTH WEST 6H | Tracr # | Distance | Wellbore |
|------------------------|---------|-----------|-----------|
| | 2667 | 189' | |
| | 2693* | 72' | |
| | 2694 | 211' | |
| | 2842 | 69' | |
| | 2852 | 91' | |
| | 2857 | 147' | Traversed |
| | 2891 | 147' | Traversed |
| | 2945* | 32' | Traversed |
| | 2954 | 93' | |
| | 3012 | 32' | |
| | 3086 | Traversed | |
| | 3089 | Traversed | |
| | 3094 | 216' | |
| | 3143 | 153' | |
| | 3188 | 233' | |
| | 3197 | Traversed | |
| | 3203 | 180' | |
| | 3220 | 19' | |
| | 3230 | 242' | |
| | 3246 | 95' | |
| | 3248 | 119' | |
| | 3289 | Traversed | |
| | 3307.1 | 221' | |
| | 3311* | 10' | |
| | 3339* | 108' | |
| | 3342* | 37' | |
| | 3346 | Traversed | |
| | 3373* | 80' | |
| | 3374 | 13' | |

*Partial Lease

THIS PLAT WAS PREPARED FROM RECORDS FURNISHED TO REPRESENT THE ROSEDALE SOUTH AND WEST UNITS AND THE MINERAL TRACTS WITHIN THOSE UNITS FOR THE SOLE PURPOSE OF VANTAGE FORT WORTH ENERGY, LLC, AND DOES NOT REPRESENT A BOUNDARY SURVEY.

Rosedale South West 6H MIPA Unit Description

BEING a 88.079 acre tract of land situated in the J. Creary Survey, Abstract Number 269, the U. Wuthrick Survey, Abstract Number 1693, and the G.J. Ashabranner Survey, Abstract Number 7, Tarrant County, Texas and being more particularly described by metes and bounds as follows:

COMMENCING at the northeast corner of Lot 1, Block F, Melody Oaks, an addition to the City of Fort Worth recorded in Volume 388-11, Page 112, Plat Records, Tarrant County, Texas:

THENCE N 56°57'11" E, 632.49 feet to the **POINT OF BEGINNING**;

THENCE N 63°50'35"W, 315.20 feet;

THENCE N 66°46'08"W, 229.10 feet;

THENCE N 65°53'45"W, 769.91 feet;

THENCE N 67°56'49"W, 1458.88 feet;

THENCE N 67°16'38"W, 2430.51 feet;

THENCE N 69°03'25"W, 625.92 feet;

THENCE N 71°18'29"W, 1163.24 feet;

THENCE N 71°39'03"W, 1374.89 feet;

THENCE N 00°17'40"W, 140.39 feet;

THENCE S 89°40'24"W, 27.80 feet;

THENCE N 00°46'57"W, 422.41 feet;

THENCE N 00°47'03"W, 3.74 feet;

THENCE N 01°46'27"E, 5.05 feet;

THENCE S 70°20'59"E, 121.82 feet;

THENCE S 70°18'26"E, 1465.01 feet;

THENCE S 70°47'06"E, 1168.93 feet;

THENCE S 66°26'10"E, 650.56 feet;

APPENDIX 4A

THENCE S 66°19'12"E, 2420.03 feet;
THENCE S 67°03'57"E, 1470.39 feet;
THENCE S 65°44'34"E, 1610.55 feet;
THENCE S 81°17'06"W, 14.33 feet;
THENCE S 61°43'05"W, 10.15 feet;
THENCE S 75°24'34"W, 19.57 feet;
THENCE S 65°12'22"W, 23.01 feet;
THENCE S 77°58'23"W, 12.24 feet;
THENCE S 89°20'38"W, 6.99 feet;
THENCE S 70°45'23"W, 14.78 feet;
THENCE S 89°15'38"W, 6.99 feet;
THENCE S 67°48'29"W, 19.35 feet;
THENCE S 58°40'12"W, 13.94 feet;
THENCE S 71°08'49"W, 7.36 feet;
THENCE S 62°24'23"W, 15.70 feet;
THENCE S 45°02'54"W, 16.76 feet;
THENCE S 27°17'19"W, 10.64 feet;
THENCE S 11°20'36"W, 9.61 feet;
THENCE S 34°26'31"W, 8.68 feet;
THENCE N 82°11'10"W, 16.18 feet;
THENCE S 89°18'43"W, 5.00 feet;
THENCE S 74°21'06"W, 9.30 feet;

THENCE S 55°28'50"W, 8.44 feet;
THENCE S 51°12'19"W, 15.24 feet;
THENCE S 55°26'29"W, 8.43 feet;
THENCE S 44°20'46"W, 9.90 feet;
THENCE S 22°14'29"W, 12.81 feet;
THENCE S 23°52'16"E, 7.61 feet;
THENCE S 14°58'03"W, 11.08 feet;
THENCE S 87°56'19"W, 10.01 feet;
THENCE S 46°12'42"W, 15.07 feet;
THENCE S 22°20'01"W, 5.10 feet;
THENCE S 44°15'51"W, 9.90 feet;
THENCE S 22°26'41"W, 5.11 feet;
THENCE S 35°58'15"W, 11.71 feet;
THENCE S 46°03'43"W, 6.86 feet;
THENCE S 31°53'45"W, 5.58 feet;
THENCE S 55°26'33"W, 8.43 feet;
THENCE S 39°40'28"W, 6.17 feet;
THENCE S 58°40'09"W, 13.94 feet;
THENCE S 63°00'34"W, 21.20 feet;
THENCE S 70°20'33"W, 7.40 feet;
THENCE S 74°57'58"W, 9.29 feet;
THENCE S 70°24'52"W, 7.40 feet;

THENCE N 77°10'48"W, 10.28 feet;

THENCE S 89°16'13"W, 11.00 feet;

THENCE N 68°01'43"W, 6.82 feet;

THENCE S 56°57'13"W, 40.96 feet, to the **POINT OF BEGINNING** and containing 3,836,727 square feet or 88.079 acres of land more or less.