

**Appendix 1**  
**Oil & Gas Docket No. 08-0316751**  
**Colgate Operating, LLC**

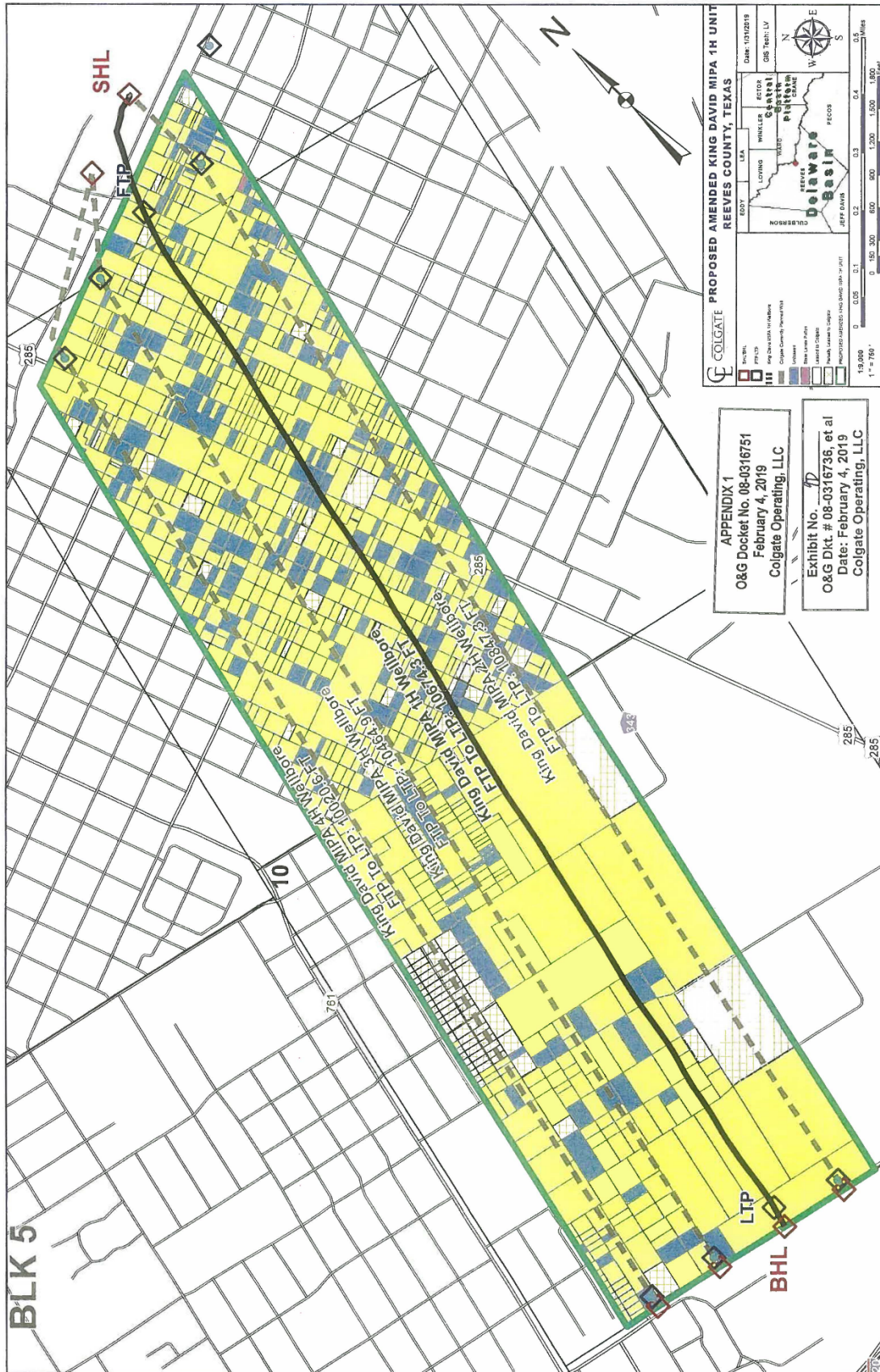

# **Appendix 2** **Oil & Gas Docket No. 08-0316751** **Colgate Operating, LLC**

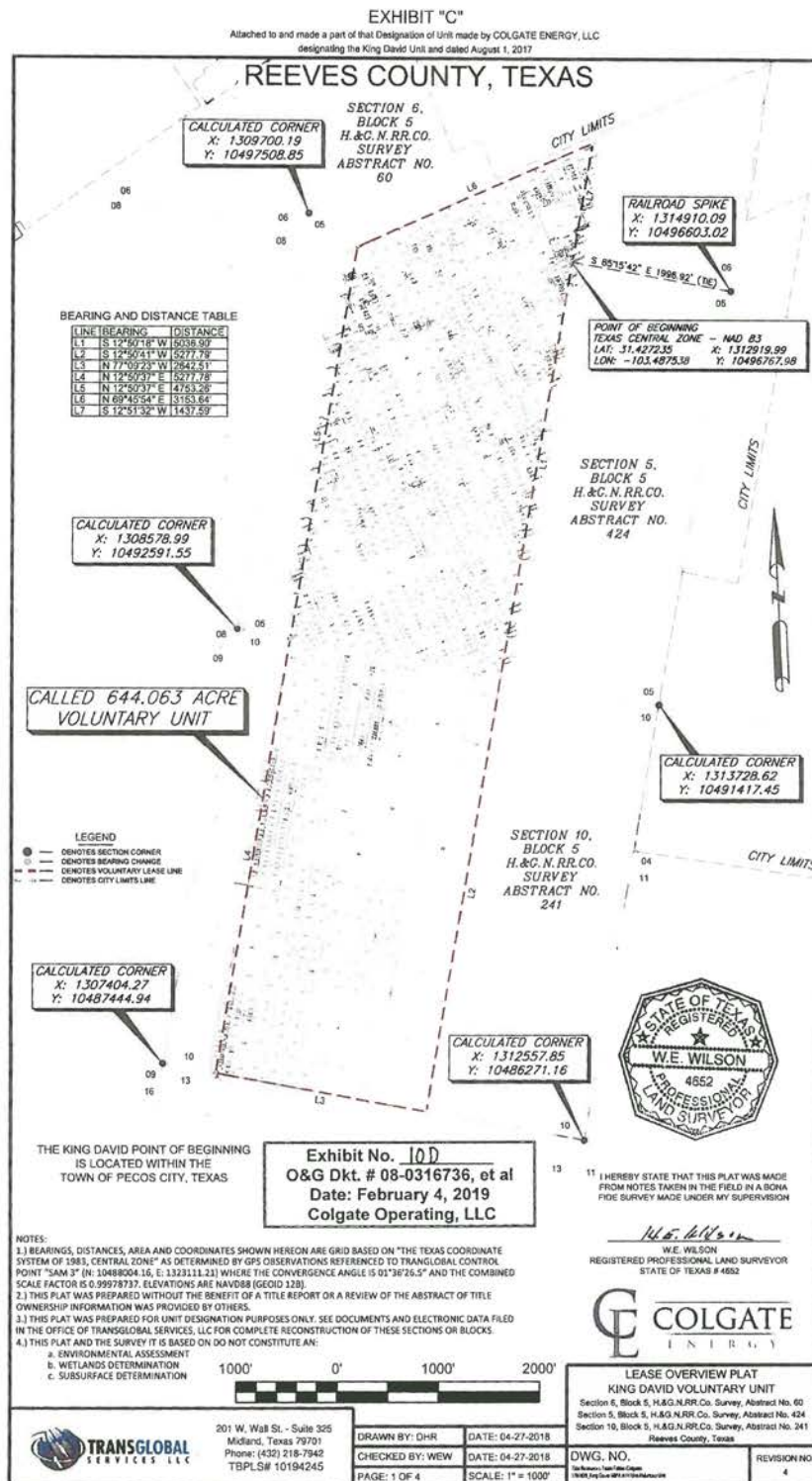

**APPENDIX 2**  
**O&G Docket No. 08-0316751**  
**February 4, 2019**  
**Colgate Operating, LLC**

REEVES COUNTY, TEXAS

METES AND BOUNDS DESCRIPTION

BEING the metes and bounds description of a Called 644.063 acre tract situated in SECTION NO. 6, BLOCK 5, H & G.N.RR.CO. SURVEY, ABSTRACT NO. 60, Reeves County, Texas, SECTION NO. 5, BLOCK 5, H & G.N.RR.CO. SURVEY, ABSTRACT NO. 424, Reeves County, Texas and in SECTION NO. 10, BLOCK 5, H & G.N.RR.CO. SURVEY, ABSTRACT NO. 241, Reeves County, Texas

Said metes and bounds being more particularly described as follows:

BEGINNING at a point in the North section line of said SECTION NO. 5, from which a Railroad Spike found for the Northeast corner of said SECTION NO. 5, bears S 85°15'42" E, a distance of 1996.92 feet (TIE), said POINT OF BEGINNING having a TX-CENTRAL ZONE 4203, NAD 83 coordinate value of X:1312919.99, Y:10496767.98,

THENCE: S 12°50'18" W, along the East line of said called 644.063 acre tract, a distance of 5036.90 feet to a point;

THENCE: S 12°50'41" W, along the East line of said called 644.063 acre tract, a distance of 5277.79 feet to a point;

THENCE: N 77°09'23" W, along the South line of said called 644.063 acre tract, a distance of 2642.51 feet to a point;

THENCE: N 12°50'37" E, along the West line of said called 644.063 acre tract, a distance of 5277.78 feet to a point;

THENCE: N 12°50'37" E, along the West line of said called 644.063 acre tract, a distance of 4753.26 feet to a point;

THENCE: N 69°45'54" E, along the North line of said called 645.162 acre tract, a distance of 3153.64 feet to a point;

THENCE: S 12°51'32" W, along the East line of said called 644.063 acre tract, a distance of 1437.59 feet to the POINT OF BEGINNING;

Said boundary tract containing 28,055,384.28 square feet or 644.063 acres in SECTION NO. 6, SECTION NO. 5, & SECTION NO. 10.

NOTES:

- 1.) BEARINGS, DISTANCES, AREA AND COORDINATES SHOWN HEREON ARE GRID BASED ON "THE TEXAS COORDINATE SYSTEM OF 1983, CENTRAL ZONE" AS DETERMINED BY GPS OBSERVATIONS REFERENCED TO TRANSGLOBAL CONTROL POINT "SAM 3" (N: 10488004.16, E: 1323111.21) WHERE THE CONVERGENCE ANGLE IS 01°36'26.5" AND THE COMBINED SCALE FACTOR IS 0.99978737. ELEVATIONS ARE NAVD88 (GEOID 12B).
- 2.) THIS PLAT WAS PREPARED WITHOUT THE BENEFIT OF A TITLE REPORT OR A REVIEW OF THE ABSTRACT OF TITLE OWNERSHIP INFORMATION WAS PROVIDED BY OTHERS.
- 3.) THIS PLAT WAS PREPARED FOR UNIT DESIGNATION PURPOSES ONLY. SEE DOCUMENTS AND ELECTRONIC DATA FILED IN THE OFFICE OF TRANSGLOBAL SERVICES, LLC FOR COMPLETE RECONSTRUCTION OF THESE SECTIONS OR BLOCKS.
- 4.) THIS PLAT AND THE SURVEY IT IS BASED ON DO NOT CONSTITUTE AN:
- a. ENVIRONMENTAL ASSESSMENT
  - b. WETLANDS DETERMINATION
  - c. SUBSURFACE DETERMINATION



201 W. Wall St. - Suite 325  
Midland, Texas 79701  
Phone: (432) 218-7942  
TBPLS# 10194245

DRAWN BY: DHR	DATE: 04-27-2018
CHECKED BY: WEW	DATE: 04-27-2018
PAGE: 2 OF 4	SCALE: 1" = 1000'

LEASE OVERVIEW PLAT  
KING DAVID VOLUNTARY UNIT  
Section 6, Block 5, H.&G.N.RR.Co. Survey, Abstract No. 60  
Section 5, Block 5, H.&G.N.RR.Co. Survey, Abstract No. 424  
Section 10, Block 5, H.&G.N.RR.Co. Survey, Abstract No. 241  
Reeves County, Texas

DWG. NO. <small>Title Resources Team Folder Colgate 1787933_King David MPA 2011 Unit Voluntary Unit</small>	REVISION NO. 4
--	-------------------